

Foreword

Congratulations on your purchase of a high quality archery product. Please read all instructions thoroughly prior to assembly and use. For more information including the most current version of this document, visit www.bowkaddy.com.

Contents and Assembly

#	Qty	Size	Description
1	1	-	Base
2	1	-	Main Support Arm
3	1	-	Left Swing Arm
4	1	-	Right Swing Arm
5	1	-	ATV Bracket
6	1	5/16"	J-Bolt
7	4	5/16" x 1 1/4"	Bolt
8	1	1/4" x 2"	Quick release pin
9	1	1/4" x 2 1/2"	Bolt
10	3	1/4"	Flat washer
11	9	5/16"	Flat washer
12	1	1/4"	Lock washer
13	1	1/4"	Nut
14	4	5/16"	Nut
15	2	1/4"	Wing nut
16	2	1/4" x 1 1/2"	Rubber washer
17	2	1/4" x 1 1/4"	Carriage bolt
18	5	5/16"	Lock washer
19	1	5/16"	Wing nut
20	2	5/16"	Quick release pin
21	1	Universal	Bow Kover
22	1	-	Hole Template
23	1	-	Product Sheet

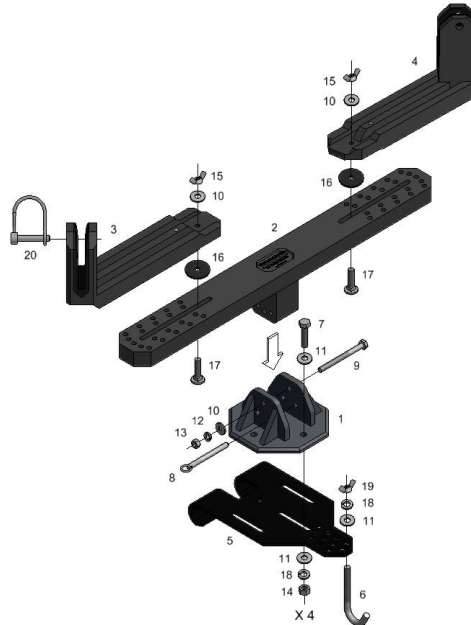

Tools Required

- Two 7/16" or adjustable wrenches
- Two 1/2" or adjustable wrenches
- May require drill and 1/4" bit

Assembly Notes

- The ATV Bracket (5) is intended for use on metal ATV racks only
- Despite the array of hole positions on top of the Main Support Arm (2), it may sometimes be necessary to drill additional holes in the Main Support Arm to accommodate the particular limb angle of your bow
- The Left (3) and Right (4) Swing Arms are reversible
- The quick release pin (8) and the 2 1/2" bolt (9) can be inserted from either side
- Note the orientation of the J-Bolt (6); this is critical to the stability of the ATV Bracket
- The ATV Bracket can be oriented in any direction depending on the configuration of the ATV rack
- The wing nuts need only be hand-tight

Installation Applications

Bowkaddy can be mounted in various locations. The most common installations are explained below. To learn more about these and other installations, visit www.bowkaddy.com.

ATV / Four Wheeler

Bowkaddy is typically mounted on the front or rear racks, but can also be mounted to other structurally rigid areas such as storage and tool boxes. For ATV's with composite racks (ie. Polaris, Can-Am, etc.), the ATV Bracket is not used. Rather, the base must be direct fastened to a structurally rigid or reinforced area. **Note that this situation requires holes to be drilled in the composite structure.** Position the base of Bowkaddy on the ATV bracket such that at least 3 of the 4 bolts are utilized. The J-bolt may take the place of the last bolt depending on the width between the ATV rack tubes/channels. Note the positioning and orientation of the J-bolt as it is critical to the rigidity of the ATV bracket.



Crossbow Application - If you're planning to use Bowkaddy to support the limbs of a crossbow, the mounting location will move from the middle of the ATV rack to the left or right side. A conventional gun grip (available at many sporting goods stores) will be needed on the opposite side of the rack to support the stock of the crossbow. Front and rear mounts are often possible.



UTV / Side by Side

UTV installations are typically done with the UTV Bracket (**sold separately**). The bracket is U-bolted to adjacent roll bars and then Bowkaddy is fastened to the bracket. The bracket can accommodate two bows for tandem hunting.



Truck / SUV

Bowkaddy can also be mounted in or on regular vehicles such as pickups and SUV's. Regardless of the selected location, remember the basic installation rules – location must be flat, rigid and drillable, since the base will be direct fastened (the ATV bracket is not required). Always start by positioning your bow in Bowkaddy in the anticipated mounting location to ensure adequate clearance and easy access. In the case of a cab mount, be sure to avoid drilling into electrical or HVAC conduits. Lag or self-tapping bolts (not included) may be needed for this mounting application.



Other

The sky is pretty much the limit on where you can mount and use Bowkaddy. Boats, workbenches and display walls are but a few examples. The only prerequisites are that the surface be flat and rigid and that consideration be given to bow clearance and access when the bow is in place.

Use, Care and Maintenance

- Only use to store and transport archery bows and crossbows. Not intended for general load securement.
- Adjust position of the Swing Arms to match bow limb angles. If one or more of the pins in the Swing Arms don't line up well with the pre-existing holes in the Main Support Arm, you'll need to drill one or two additional holes in the Main Support Arm. This is accomplished using the Hole Template provided. Start by sliding the Hole Template over one end of the Main Support Arm with the hole facing upward. Next, insert the bow into the limb grips of the detached Swing Arms. Then place the Swing Arms on top of the Main Support Arm, aligning the carriage bolts and the pin on the underside of the Swing Arm with the hole in the Hole Template. When everything looks good (based on symmetry and/or proximity to other holes), the Swing Arms and bow can be removed. As much as possible, try to keep the new hole away from existing holes. Using a drill and 1/8" bit, drill partially through the Main Support Arm at the location of the hole in the Hole Template. It is not necessary to go deeper than the existing holes in the Main Support Arm. Go slow and use caution when drilling as it is very easy to drill deeper than intended. If necessary, repeat for the opposite side of the Main Support Arm. The Hole Template can then be removed and the Bowkaddy re-assembled, now offering a new custom fit for your bow.
- Check nut and other fasteners regularly to ensure that they remain tight.
- Insert/remove bow one limb at a time by applying equal and opposite forces to the limb and swing arm. Do not use excessive force.
- The quick release pins should be used if there is a possibility of the bow bouncing or falling out of the limb grips.
- The Bowkaddy Bow Kover is intended for use in areas where mud and debris could get onto the bow during transit.
- The Bowkaddy Bow Kover also provides a legal alternative to a cased bow in states/provinces where it is accepted.
- Fold swing arms inward and secure with wing nuts for compactness when not in use.
- Do not subject Bowkaddy to unnecessary impact or overload.
- Not for use or play by young children. Rotating Swing Arms can create a pinch hazard.

Warranty & Disclaimer

Bowkaddy and accessories are designed for maximum mounting versatility. However, if the original purchaser is unable to acceptably mount Bowkaddy or is otherwise dissatisfied with the product, Alaris Concepts will accept a return shipment of the product with proof of purchase in exchange for a refund equal to the purchase price. When assembled, installed and used as per the instructions contained in this Product Sheet, Alaris Concepts warrants to the original purchaser any original product defects for a period of 5 years. Damage to Bowkaddy, archery equipment and/or vehicle resulting from poor installation and/or misuse of the product is not covered by Alaris Concepts. Alaris Concepts reminds all users to know and follow all applicable regulations governing the transportation and deployment of archery weapons. For further warranty information and processing, general information or feedback, contact Alaris Concepts in Wainwright, Alberta, Canada. Phone: (780) 842-7150. Email: info@alarisconcepts.com. Website: www.alarisconcepts.com.